

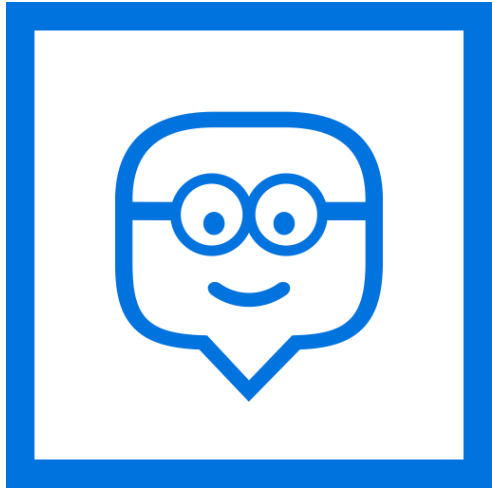

ALTINBAS
UNIVERSITY



HOW TO USE MICROSOFT TEAMS

WHAT IS MS TEAMS?

It is a programme. We use it to join our online classes or have our speaking tasks.

You can download it to your computer, tablet or phone.



Microsoft Teams





How to login to MS Teams?



Follow the steps



- First, download the programme or the app.
- Use your altinbas mail address to log in.
(e.g. 21.....@ogr.altinbas.edu.tr)
- Your password is the same as your altinbas mail password.

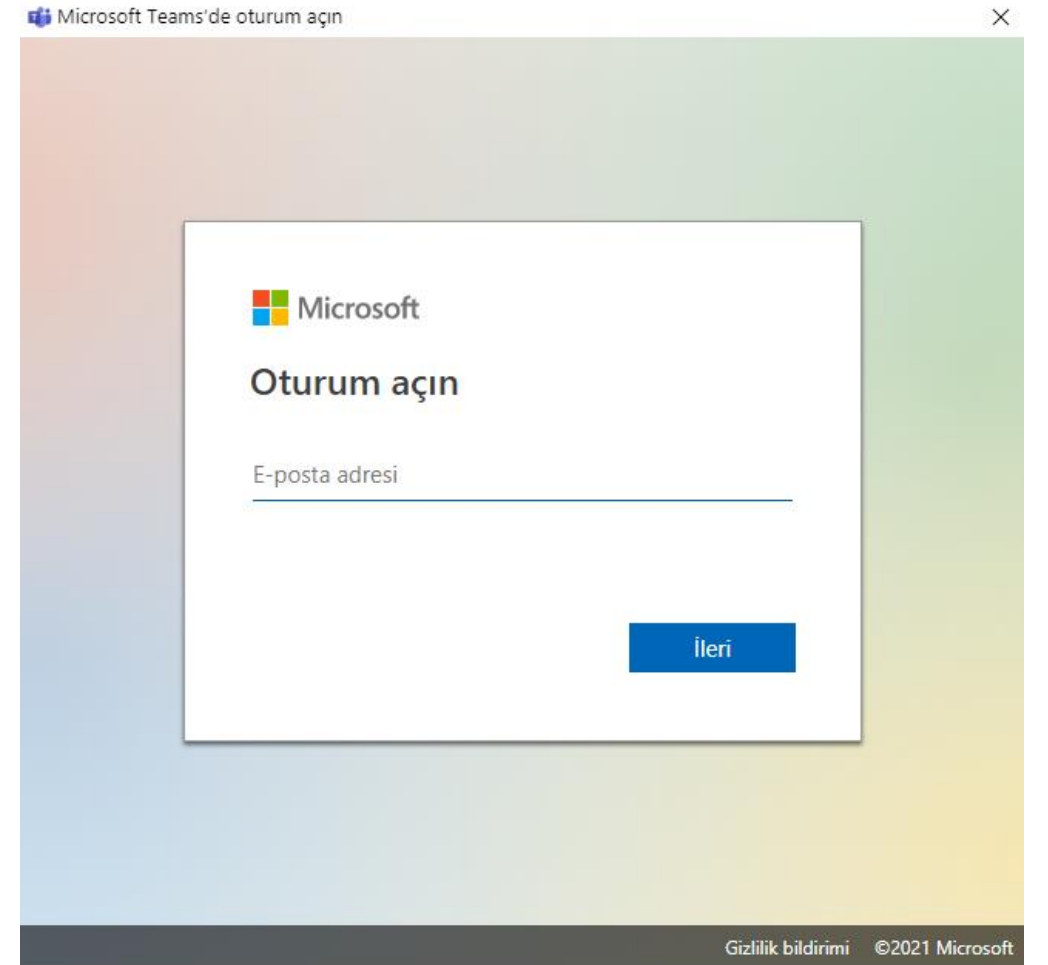

Your teacher will add you to your MS Teams class.
Go to «Ekipler/Teams» to find your class and click on it

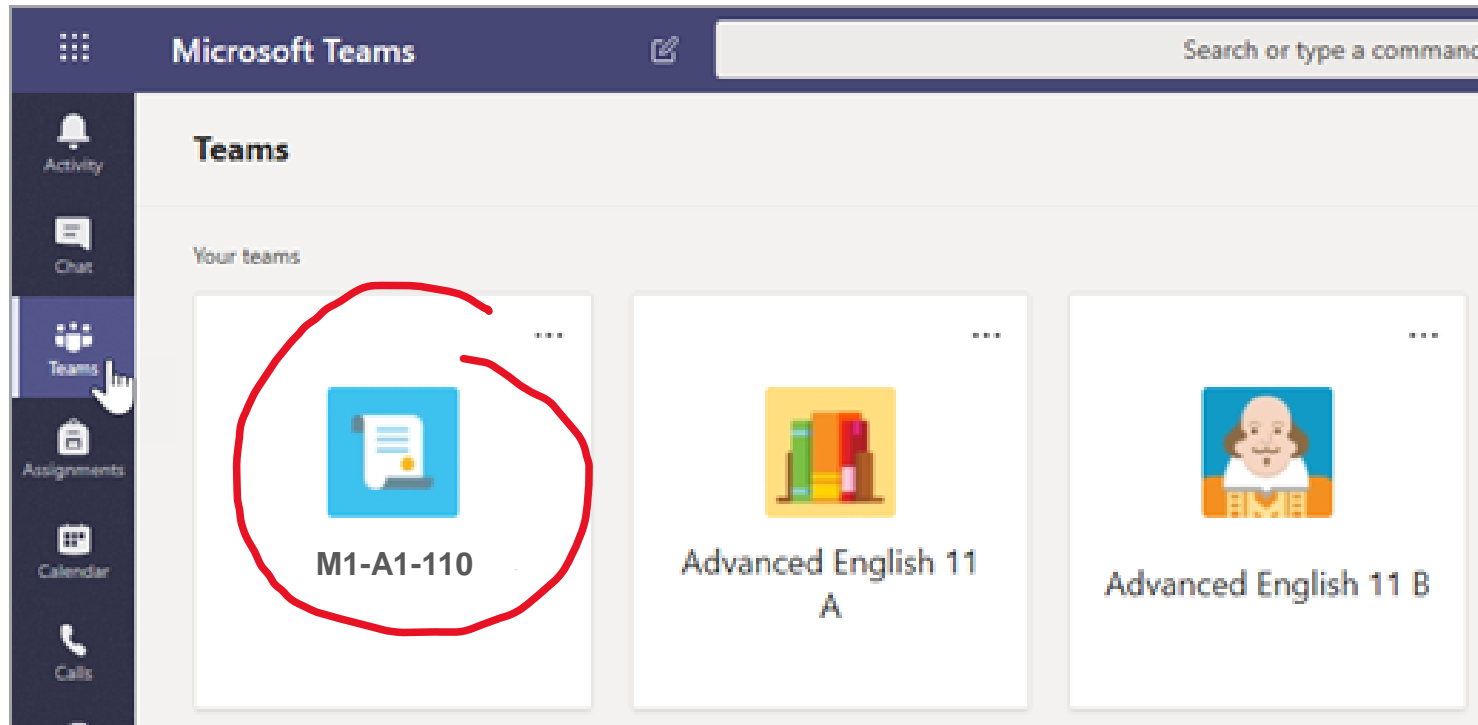

- Open your online class on MS Teams before your lesson.
- You will see the meeting, click «katıl/join» to join your class.



Click on «join now/řimdi katıl» and join the lesson.

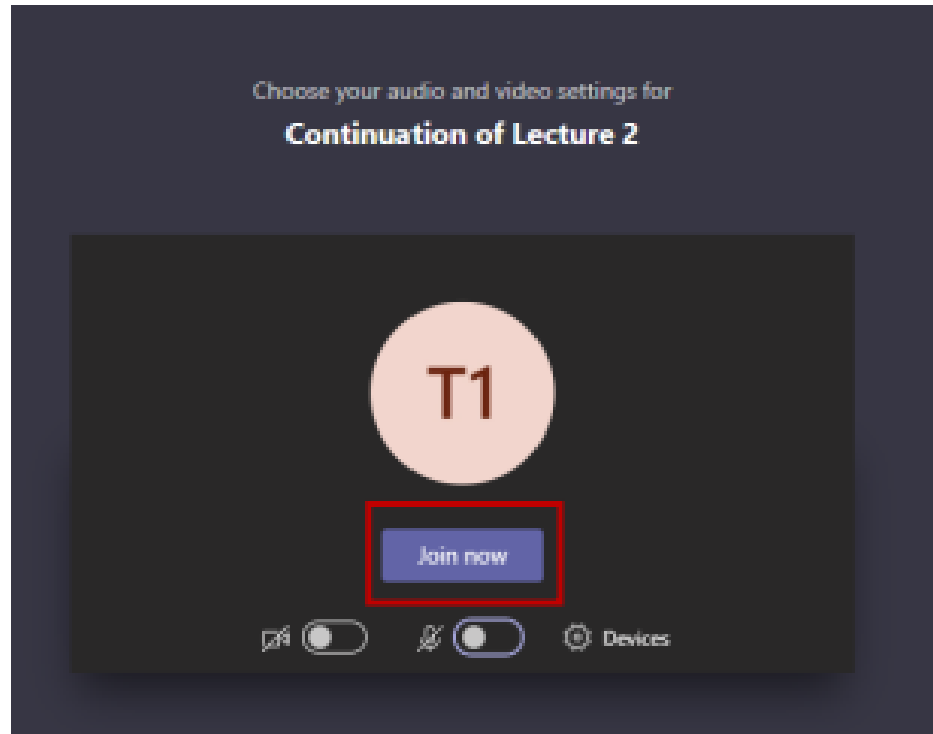

- When you join your online class, you will see the bar below.

MS Teams control-What is this..?

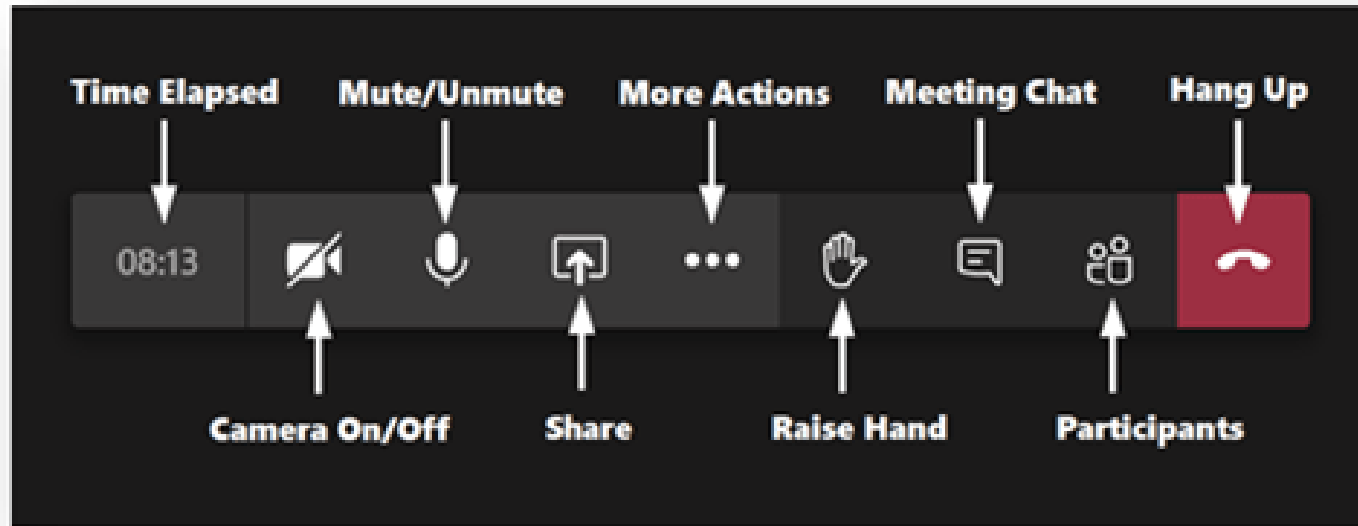

More features...

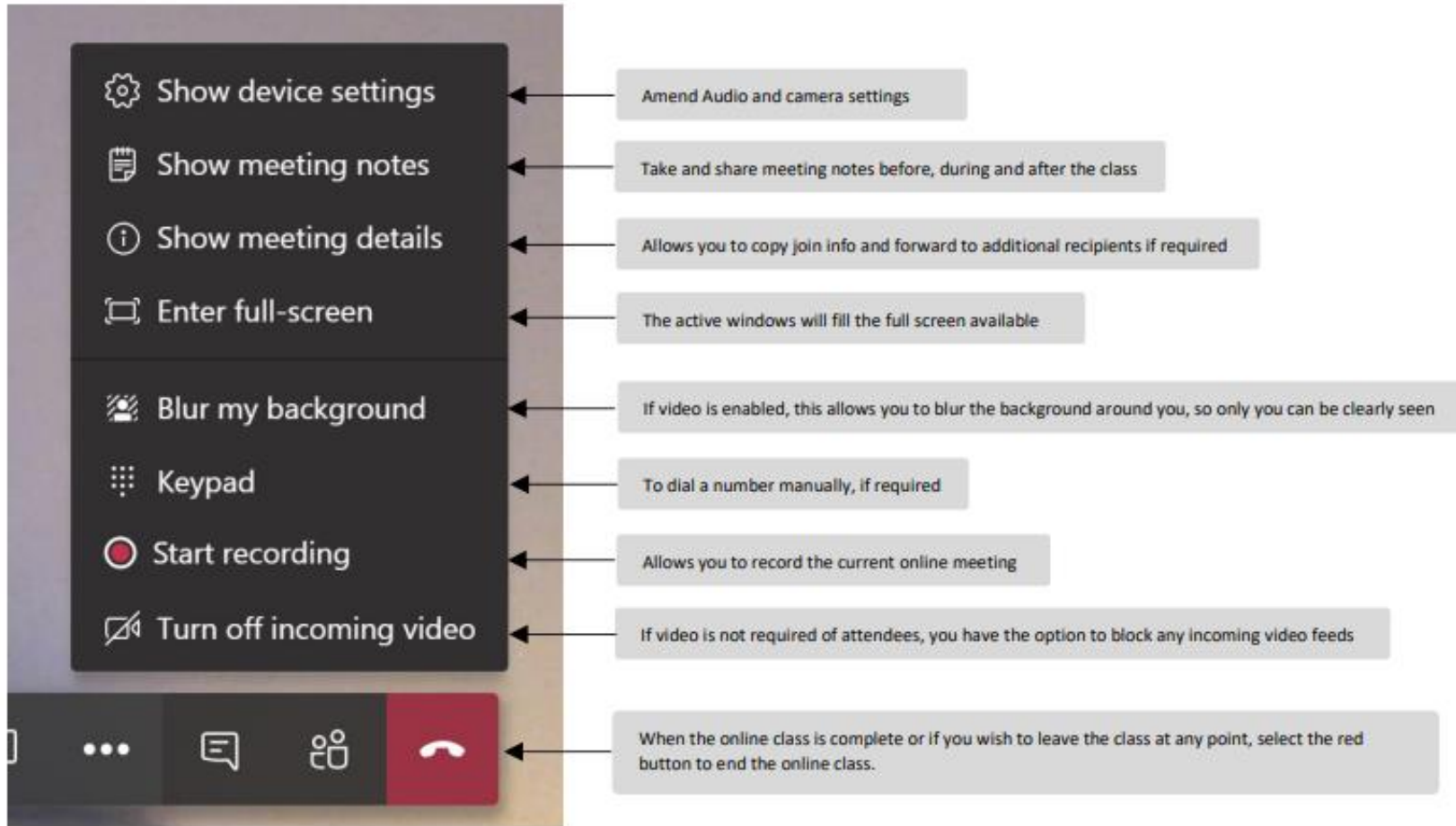



ALTINBAŞ
UNIVERSITY

